

RURAL TEXAS TOURISM LLC

RURAL TEXAS TOURISM LLC

www.ruraltexastourism.com

cc@cvctx.com

979-561-6667

FOR IMMEDIATE RELEASE

Contact: Schulenburg Area Food Pantry
Cathy Chaloupka--Marketing Coordinator
Phone: 979-561-6667
E-Mail: schulenburgareafoodpantry@cvctx.com

Capital Campaign for More Space Kicks Off with the Schulenburg Area Food Pantry (SAFP)

(part one of a series)

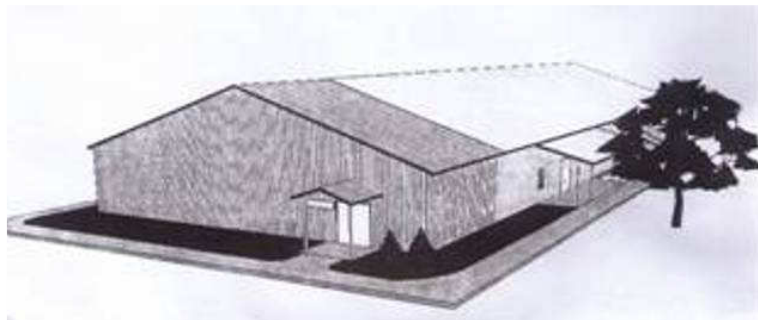

Rendition of addition

“We have to have more space than ever to store food because the need has grown tremendously.” “There are so many more people (from children to seniors) that do not have enough food at their tables at some point during the month—this is where their necessary supplement of food comes from.” “Incredible to believe, but 1500-9000 pounds of food are passed out monthly right here.” Before you stop reading this and think these are words from a writer’s observation in some dark part of the world, let’s clue you in--it’s coming from the Board of Directors and volunteers in the small community of Schulenburg with the Schulenburg Area Food Pantry (SAFP) and is why the SAFP Capital Campaign has been conceived.

Don't let the term "Capital Campaign" scare you away—it's just big words for a necessary project—*getting money to add more space to store more food to feed more people--that simple.* The location is at 1107 Hillje and is the southernmost portion of the Schulenburg Civic Center building. The Board of Directors involved is familiar names to the area and includes: Kathy Quinlan (President), Rose McClain (Vice-President), Rita Brossmann (Secretary), Ronnie Herzik (Treasurer). Board members are: Tom Bargas, Susie Stewart, Debra Blansitt, Robert Fulton, and Annie Chapman. Coordinator for the campaign is Cathy Chaloupka of Rural Texas Tourism, LLC.

Funding needed is approximately \$190,000.00 with \$85,000 already pledged through donors (some anonymous) and the Sanford Schmid Foundation. The City of Schulenburg has graciously voted unanimously to allow the use of city equipment and personnel for the project in the last City Council meeting. Second Chance Emporium has continued to donate \$500.00/per month towards food needs directly.

"At this time businesses, organizations, and individuals are asked to step up and make a pledge towards the completion of this endeavor," states Kathy Quinlan, President to the Board of SAFFP. "This is a one time project that is crucial for the community of Schulenburg. Everyone that is reading this is asked to stop for a moment and realize that the building must expand because the need for food in our wonderful community of Schulenburg has grown. At the same time, make a financial pledge from your heart. This is your community."

Pledges or checks may be mailed to the Schulenburg Area Food Pantry at P.O. Box 146, Schulenburg, Texas, 78956. Please include your name, address, phone number, and e-mail address and a note if you wish to remain anonymous or not. Questions may be e-mailed to schulenburgareafoodpantry@cvctx.com or call Cathy Chaloupka, Coordinator at 979-561-6667." Future articles will include more information regarding the building, statistics on hunger in the area, and recognition of donors.

###

***Cathy Chaloupka
Rural Texas Tourism, LLC***

